

HOTEL 1Q26 Webcast

Santa Fe
grupo | hotelero

April 24th, 2026



Empresa Socialmente Responsable

Revenue Growth

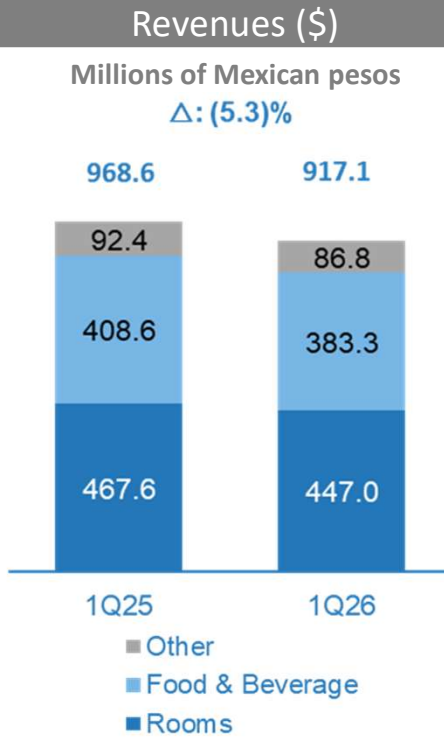

- **Total Revenue** was Ps. 917 million in the quarter, a decrease of 5% compared to 1Q25
- **Room revenue** was Ps. 447 million in the quarter, a decrease of 4% compared to 1Q25
- **F&B revenue** was Ps. 383 million in the quarter, a decrease of 6% compared to 1Q25
- **Other revenue** was Ps. 87 million in the quarter, a 6% decrease compared to 1Q25.

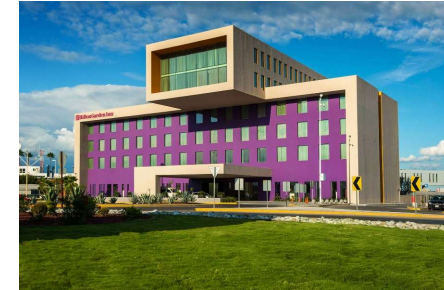

Hilton Garden Inn Monterrey Aeropuerto



Krystal Urban Guadalajara

5.1 Operational KPIs (Total Hotels in Operation)

Occupancy (%)

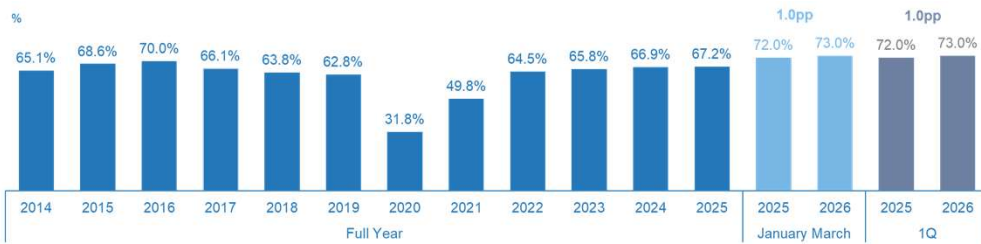

ADR (\$) (Pesos)

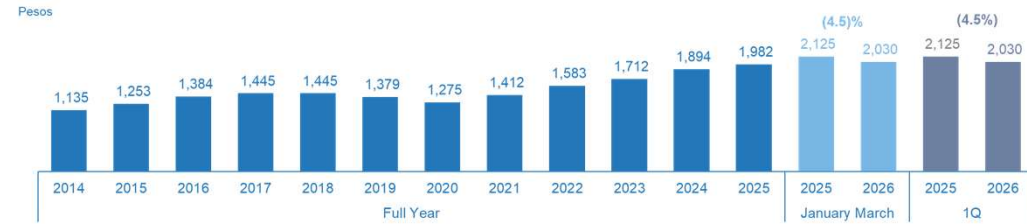

RevPAR (\$) (Pesos)

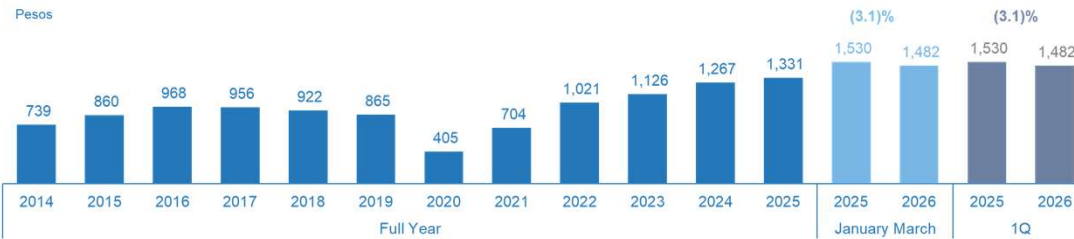

Bottom Line Performance

Operating Income(\$)

Millions of Mexican pesos

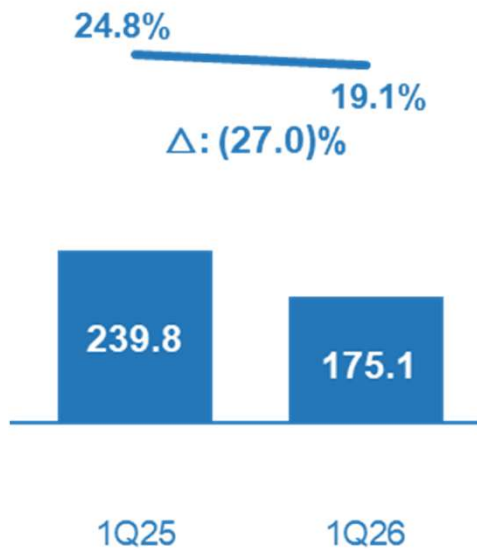

EBITDA (\$)

Millions of Mexican pesos

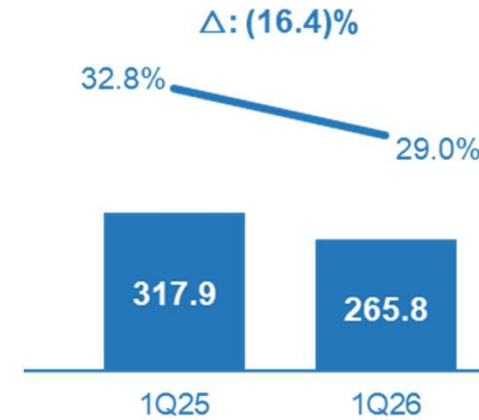

Financial Debt

Figures in thousands of Mexican pesos

Debt*	Denominated in (currency):		
	Pesos	Dollars	Total
Short Term	-	290,592	290,592
Long Term	-	2,057,554	2,057,554
Total	-	2,348,146	2,348,146
% Total	0.0%	100.0%	100.0%
Average rate of financial liabilities		7.37%	7.37%
Cash and cash equivalents	290,417	312,156	602,573
Restricted cash	-	114,709	114,709
Cash and cash equivalents**	290,417	426,865	717,282
Net Debt	(290,417)	1,921,282	1,630,864

Net Debt / LTM EBITDA (as of March 31, 2026) **1.9x**

*Includes accrued interest and effect of financial instruments related to financial debt.

**Includes restricted cash related to bank debt.

Debt Maturity Profile of Grupo Hotelero Santa Fe
as of March 31, 2026

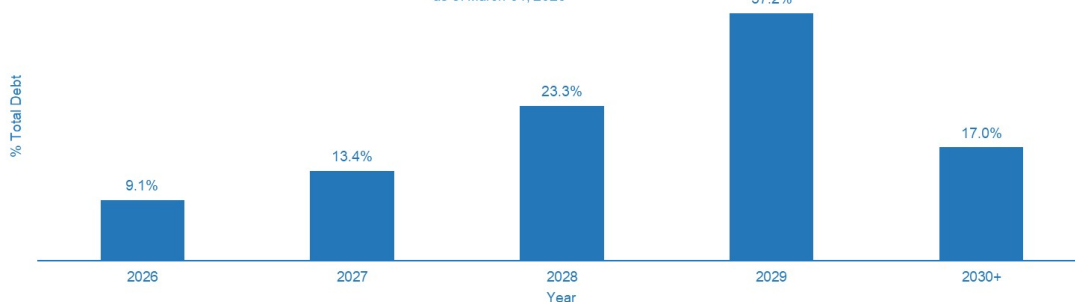

- During 1Q26, the Mexican peso depreciated **0.8%**, from Ps. 17.9528 on December 31, 2025, to Ps. 18.1033 as of March 31, 2026, negatively impacting the Company's financial cost. **The Company's short US dollar position at the end of 1Q26 was US\$106 million**, equal to Ps. 1,921 million
- Net Debt was Ps. **1,630** million at the end of 1Q26, which represented a Net Debt/LTM EBITDA ratio of **1.9x**.

Q&A Session



Enrique Martínez Guerrero
CFO
emartinez@gsf-hotels.com

Rodrigo Ancira Fuentes
Investor Relations Director
rodrigo@gsf-hotels.com
+52 (55) 5261-0800

Visit our website:
www.gsf-hotels.com



Secrets Tulum Resort



Secrets Tulum Beach Club